

KAYICI ÇATAL - SLEEVE YOKE

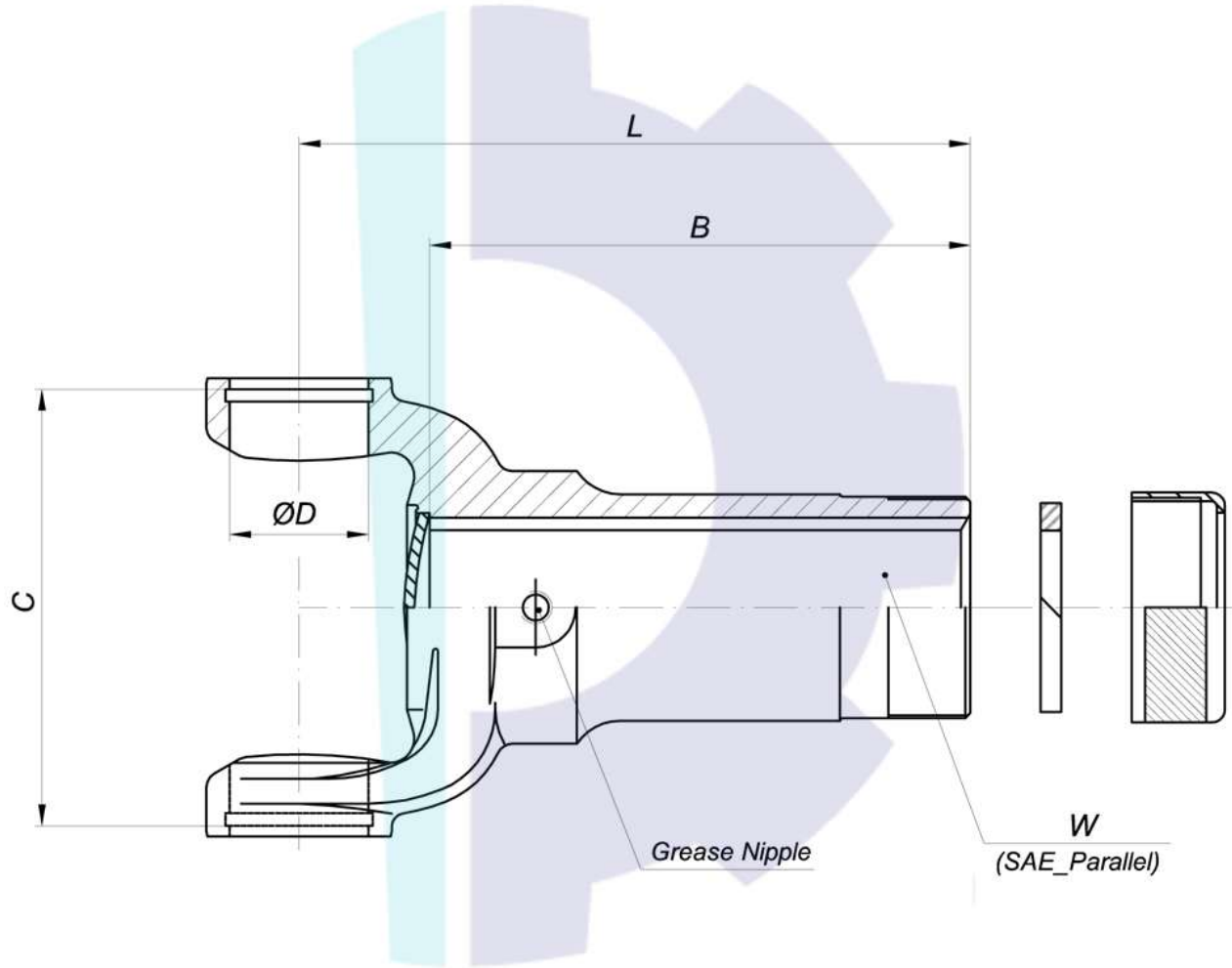

SERİ SERIE	PARÇA NO PART NO	ØD	B	L	C	MAFSAL AÇISI JOINT ANGLE	W SPLINE	İSTAVROZ U.JOINT
68730	SY.68730.01.02	35 ^{+0,025}	139	172	109,296 ^{-0,05}	20°	SAE Ø44,45x16C	Ø35x106,4
	SY.68730.02.02	35 ^{+0,025}	127	204	106,895 ^{-0,05}	28°	JIS Ø40x22x1,667	Ø35x104
01140	SY.01140.01.02	23,825 ^{-0,018}	88,2	109,5	64,26 ^{-0,05}	15°	SAE Ø26,9x16C	Ø23,825x61,2
	SY.01140.09.02	23,825 ^{-0,018}	64,6	85,8	64,26 ^{-0,05}	15°	SAE Ø26,9x16C	Ø23,825x61,2
	SY.01140.28.02	23,825 ^{-0,018}	103,3	131	64,26 ^{-0,05}	15°	DIN N27x1,5x30°x16	Ø23,825x61,2
01300	SY.01300.01.02	27 ^{-0,018}	111,6	137	77,57 ^{-0,05}	17°	SAE Ø34,9x16C	Ø27x74,6
	SY.01300.04.02	27 ^{-0,018}	129,1	155,5	77,57 ^{-0,05}	17°	SAE Ø38,1x16C	Ø27x74,6
01310	SY.01310.01.02	27 ^{-0,018}	111,6	137	84,78 ^{-0,05}	20°	SAE Ø34,9x16C	Ø27x81,8
	SY.01310.02.02	27 ^{-0,018}	163	208	84,78 ^{-0,05}	30°	SAE Ø34,9x16C	Ø27x81,8
	SY.01310.03.02	27 ^{-0,018}	121	166	84,78 ^{-0,05}	20°	SAE Ø34,9x16C	Ø27x81,8
	SY.01310.04.02	27 ^{-0,018}	58,1	83,5	84,78 ^{-0,05}	20°	SAE Ø34,9x16C	Ø27x81,8
	SY.01310.05.02	27 ^{-0,018}	130,1	155,5	84,78 ^{-0,05}	20°	SAE Ø38,1x16C	Ø27x81,8
	SY.01310.08.02	27 ^{-0,018}	123,5	168,5	84,78 ^{-0,05}	30°	SAE Ø34,9x16C	Ø27x81,8
	SY.01310.09.02	27 ^{-0,018}	120,6	146	84,78 ^{-0,05}	20°	SAE Ø34,9x16C	Ø27x81,8
	SY.01310.10.02	27 ^{-0,018}	163	208	84,78 ^{-0,05}	20°	SAE Ø34,9x16C	Ø27x81,8
	SY.01310.11.02	27 ^{-0,018}	75,6	101	84,78 ^{-0,05}	20°	SAE Ø34,9x16C	Ø27x81,8
	SY.01310.12.02	27 ^{-0,018}	109,2	137,5	84,78 ^{-0,05}	20°	SAE Ø34,9x16C	Ø27x81,8
	SY.01310.17.02	27 ^{-0,018}	105,1	130,5	84,78 ^{-0,05}	20°	SAE Ø34,9x16C	Ø27x81,8

KAYICI ÇATAL - SLEEVE YOKE

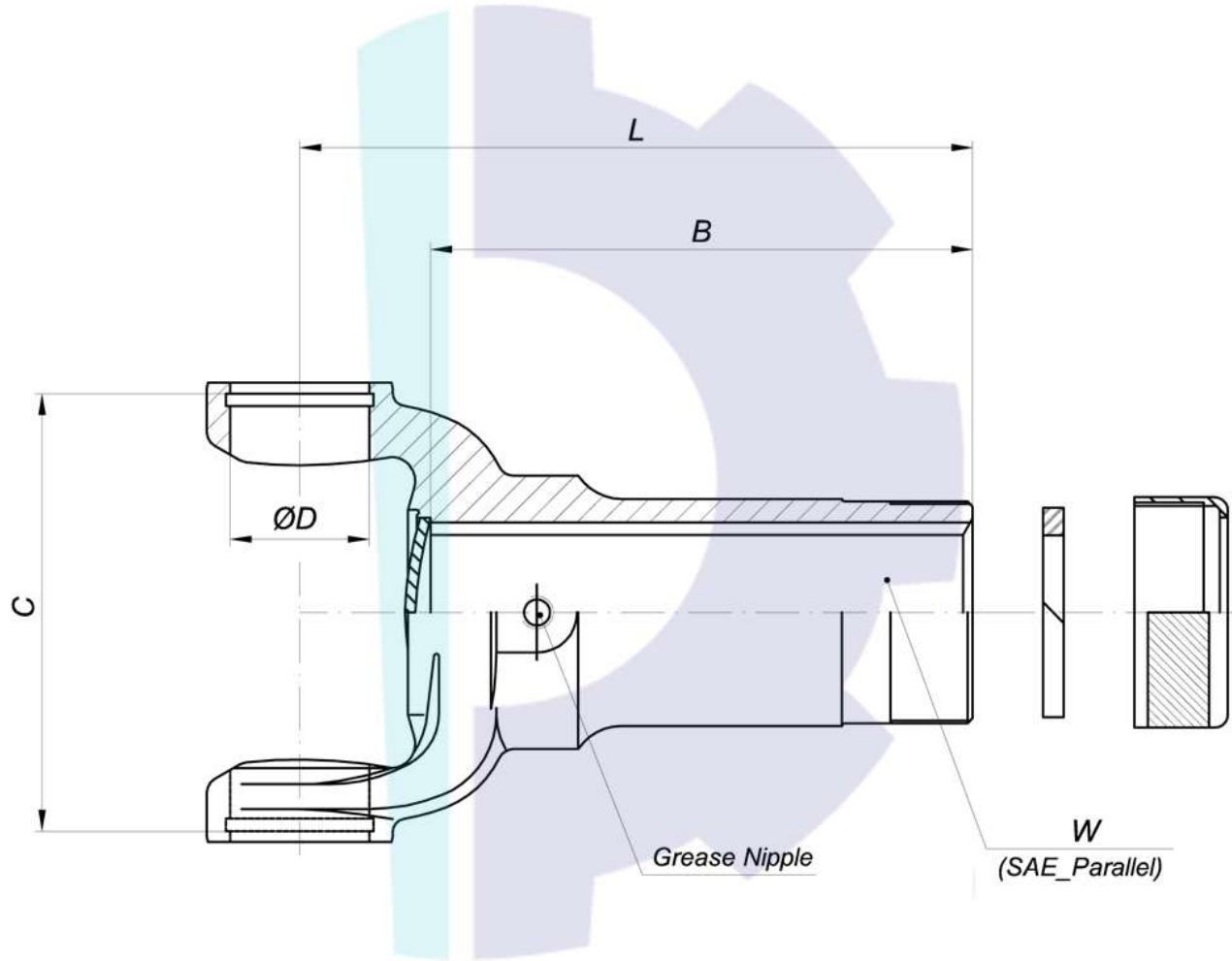

KAYICI ÇATAL - SLEEVE YOKE

SERİ SERIE	PARÇA NO PART NO	ØD	B	L	C	MAFSAL AÇISI JOINT ANGLE	W SPLINE	İSTAVROZ U.JOINT
01410	SY01410.01.02	30,175 ^{-0,018}	138	168	109,30 ^{-0,05}	20°	SAE Ø38,1x16C	Ø30,175x106,3
	SY.01410.02.02	30,175 ^{-0,018}	160,3	203,2	109,30 ^{-0,05}	30°	SAE Ø38,1x16C	Ø30,175x106,3
	SY.01410.10.02	30,175 ^{-0,018}	119,5	149,5	109,30 ^{-0,05}	20°	SAE Ø38,1x16C	Ø30,175x106,3
	SY.01410.11.02	30,175 ^{-0,018}	101,6	131,6	109,30 ^{-0,05}	20°	SAE Ø38,1x16C	Ø30,175x106,3
	RY.01410.02.02	30,175 ^{-0,018}	120	150	109,30 ^{-0,05}	20°	SAE Ø34,9x16C	Ø30,175x106,3
01480	SY.01480.01.02	34,925 ^{-0,018}	139	172	109,296 ^{-0,05}	20°	SAE Ø44,45x16C	Ø76,2x2,4
01510	SY.01510.01.02	39,68 ^{-0,018}	127	171	119,35 ^{-0,06}	20°	SAE Ø44,45x16C	Ø39,68x115,8
	SY.01510.03.02	39,68 ^{-0,018}	104	148	119,265 ^{-0,06}	20°	SAE Ø44,45x16C	Ø39,68x115,8
01550	SY.01550.01.02	34,925 ^{-0,018}	143	175	129,220 ^{-0,05}	20°	SAE Ø44,45x16C	Ø34,925x126,1
01630	SY.01630.01.02	39,68 ^{-0,018}	210,3	270	119,265 ^{-0,06}	35°	SAE Ø50,8x16C	Ø39,68x115,8
	SY.01630.02.01	39,68 ^{-0,018}	187,3	246	119,265 ^{-0,06}	35°	SAE Ø50,8x16C	Ø39,68x115,8

KAYICI ÇATAL - SLEEVE YOKE

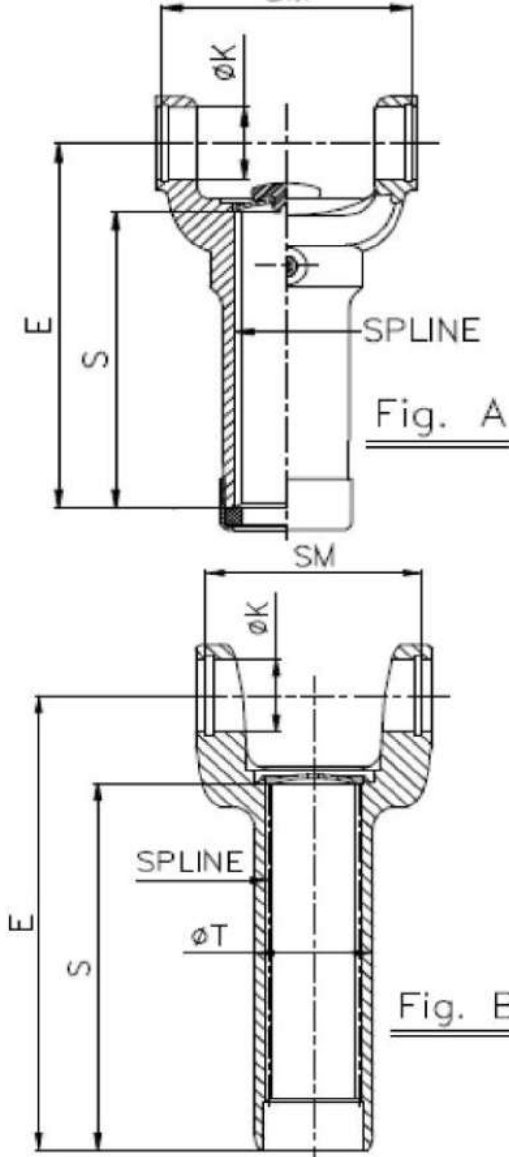

PART NO PARÇA NO	SPLINE DATA KANAL ÖLÇÜLERİ	FIG.	E	S	T	K	SM	ANGLE AÇI
114.3.KC.001.00	D=22,8;S.P=24/48;Z=20	B	135,0	99,0	30,10	23,812	64,262	14
114.4.KC.006.00	SAE 27,0x16C	A	109,5	88,0	-	23,812	64,262	17
114.3.KC.015.00	T25;24/32;30°	B	148,3	120,0	34,90	23,812	64,262	20
114.3.KC.030.00	D=22,2;M=1,25812;Z=16	B	135,0	99,0	30,10	23,812	64,262	14
114.3.KC.044.00	SAE 25,4x10C	B	149,0	122,0	32,90	23,812	64,262	20
114.4.KC.048.00	SAE 27,0x16C	A	94,0	72,0	-	23,812	64,262	17
114.4.KC.062.00	SAE 27,0x16C	A	129,0	91,0	-	23,812	64,262	30
114.3.KC.067.00	T25;24/32;30°	B	118,0	90,0	34,90	23,812	64,262	20
130.4.KC.002.00	SAE 34,9x16C	A	141,0	118,0	-	26,987	77,570	20
130.4.KC.003.00	SAE 38,1x16C	A	156,0	126,0	-	26,987	77,570	20
130.3.KC.004.00	SAE 25,4x10C	B	154,0	127,0	32,90	26,987	77,570	15
130.3.KC.005.00	T25;24/32;30°	B	154,0	124,0	34,90	26,987	77,570	15
130.4.KC.009.00	SAE 34,9x16C	A	136,6	113,0	-	26,987	77,570	20
131.4.KC.006.00	SAE 34,9x16C	A	136,6	111,0	-	26,987	84,780	20
131.4.KC.008.00	SAE 34,9x16C	A	165,9	129,0	-	26,987	84,780	30
131.4.KC.046.00	SAE 34,9x16C	A	126,0	101,0	-	26,987	84,780	20
131.4.KC.048.00	SAE 34,9x16C	A	104,0	79,0	-	26,987	84,780	20
131.3.KC.073.00	T31(32);24/32;30°	B	191,0	165,0	47,90	26,987	84,780	20
131.3.KC.077.00	T31(32);24/48;30°	B	191,0	165,0	47,90	26,987	84,780	20
131.3.KC.082.00	T23(24);24/48;30°	B	136,0	112,0	35,96	26,987	84,780	20
131.4.KC.083.00	SAE 38,1x16C	A	166,0	130,0	-	26,987	84,780	20
131.3.KC.087.00	SAE 34,9x16C	A	112,0	87,0	-	26,987	84,780	20
131.3.KC.094.00	SAE 34,9x16C	A	96,0	71,0	-	26,987	84,780	20
131.3.KC.096.00	SAE 34,9x16C	A	129,0	104,0	-	26,987	84,780	20
131.3.KC.100.00	SAE 34,9x16C	A	208,0	168,0	-	26,987	84,780	30
131.3.KC.101.00	SAE 34,9x16C	A	195,0	155,0	-	26,987	84,780	30
131.3.KC.102.00	SAE 38,1x16C	B	195,0	156,0	44,00	26,987	84,780	30
141.3.KC.065.00	SAE 38,1x16C	B	108,0	79,0	50,00	30,162	109,296	30
151.3.KC.064.00	SAE 44,5x16C	B	170,0	125,0	55,40	39,687	119,355	20

KAYICI ÇATAL - SLEEVE YOKE

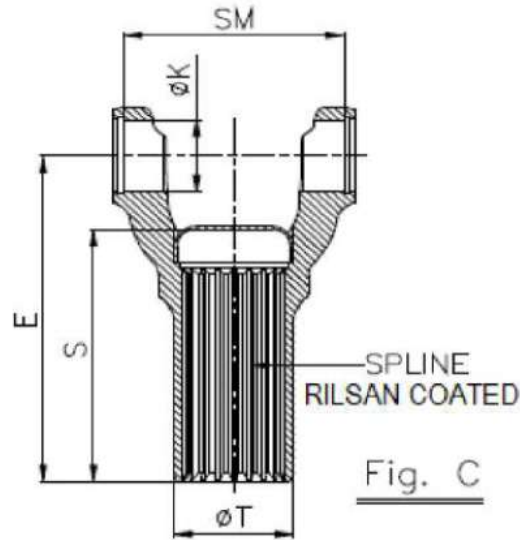
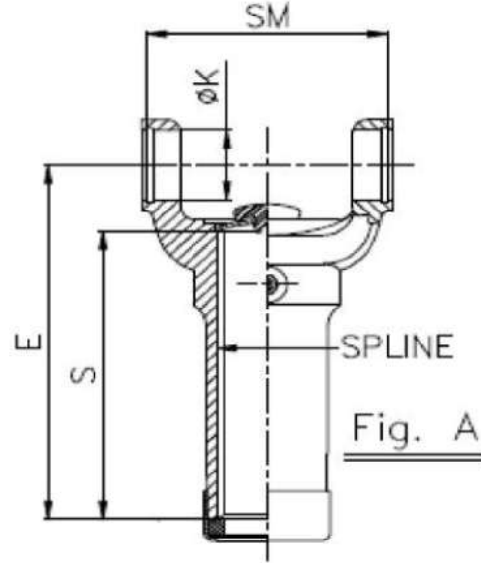

PART NO PARÇA NO	SPLINE DATA KANAL ÖLÇÜLERİ	FIG.	E	S	T	K	SM	ANGLE AÇI
141.4.KC.001.00	SAE 38,1x16C	A	168,0	138,0	-	30,162	109,296	20
141.4.KC.025.00	SAE 38,1x16C	A	193,0	160,0	-	30,162	109,296	30
141.4.KC.040.00	SAE 38,1x16C	A	100,0	70,0	-	30,162	109,296	20
141.4.KC.048.00	SAE 38,1x16C	A	124,0	94,0	-	30,162	109,296	20
141.4.KC.053.00	SAE 38,1x16C	A	142,0	112,0	-	30,162	109,296	20
141.4.KC.064.00	SAE 38,1x16C	A	137,0	107,0	-	30,162	109,296	20
148.4.KC.001.00	SAE 44,5x16C	A	173,0	141,0	-	34,925	109,296	22
148.4.KC.002.00	SAE 39,7x16C	A	173,0	141,0	-	34,925	109,296	22
148.4.KC.003.00	SAE 44,5x16C	A	142,0	110,0	-	34,925	109,296	22
148.4.KC.004.00	SAE 44,5x16C	A	120,0	78,0	-	34,925	109,296	22
148.4.KC.005.00	SAE 44,5x16C	A	157,0	124,0	-	34,925	109,296	22
148.4.KC.006.00	45x2,5x16-DIN5480	C	173,0	140,0	55*	34,925	109,296	22
151.4.KC.001.00	SAE 44,5x16C	A	170,0	126,0	-	39,687	119,355	20
151.4.KC.003.00	SAE 44,5x16C	A	135,0	91,0	-	39,687	119,355	20
151.4.KC.049.00	SAE 44,5x16C	A	150,0	105,0	-	39,687	119,355	20
151.4.KC.055.00	SAE 44,5x16C	A	195,0	135,0	-	39,687	119,355	30
163.4.KC.005.00	SAE 50,8x16C	A	267,0	207,0	-	39,687	119,355	35
432.3.KC.001.00	55x2,5x20-DIN5480	C	219,0	200,0	65*	42,000	123,000	27
432.3.KC.002.00	55x2,5x20-DIN5480	C	155,0	136,0	65*	42,000	123,000	27
432.3.KC.003.00	55x2,5x20-DIN5480	C	190,0	171,0	65*	42,000	123,000	27
740.3.KC.002.00	65x2,5x24-DIN5480	C	235,0	190,0	81*	47,625	138,465	30
740.3.KC.003.00	65x2,5x24-DIN5480	C	211,0	166,0	81*	47,625	138,465	30
740.3.KC.004.00	65x2,5x24-DIN5480	C	220,0	175,0	81*	47,625	138,465	30
740.3.KC.005.00	65x2,5x24-DIN5480	C	167,0	122,0	81*	47,625	138,465	30
740.3.KC.006.00	65x2,5x24-DIN5480	C	179,0	134,0	81*	47,625	138,465	30
755.3.KC.001.00	80x2,5x30-DIN5480	C	251,0	181,0	95*	57,000	155,963	30
755.3.KC.002.00	80x2,5x30-DIN5480	C	191,0	121,0	95*	57	155,963	30